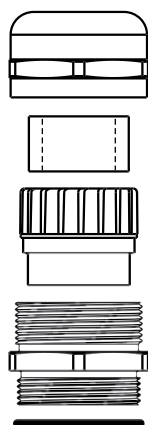
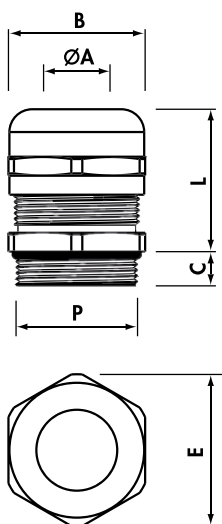

**COMPRESSION CABLE GLANDS NICKEL PLATED BRASS  
MAXIBRASS 2900 SERIES - METRIC THREAD**

**MAXIbrass<sup>®</sup> standard**
**Metric thread M 1.5 pitch CEI EN 60423 CEI EN 50262**

Ref. Nickel Plated Brass	P	Fixing Hole Ø (mm)	Ø A min-max (mm)	B Spanner (mm)	E (mm)	C (mm)	L min-max (mm)	Quantity
2900.M12N	M12X1,5	12,5	3 - 7	16	18	6,5	16-20	100
2900.M16N	M16X1,5	16,5	4,5-10	20	23	7,0	20-25	100
2900.M20N	M20X1,5	20,5	7 -13	24	27	8,0	20-27	50
2900.M25N	M25X1,5	25,5	10 -17	29	32	8,0	24-30	50
2900.M32N	M32X1,5	32,5	11 -21	36	40	9,0	27-34	25
2900.M40N	M40X1,5	40,5	19 -28	45	50	9,0	34-42	10
2900.M50N	M50X1,5	50,5	26 -35	54	60	10,0	35-43	8
2900.M63N	M63X1,5	63,5	34 -45	67	74	15,0	40-52	5

**MAXIbrass<sup>®</sup> reduced cable entry**
**Metric thread M 1.5 pitch CEI EN 60423 CEI EN 50262**

Ref. Nickel Plated Brass	P	Fixing Hole Ø (mm)	Ø A min-max (mm)	B Spanner (mm)	E (mm)	C (mm)	L min-max (mm)	Quantity
2910.M12N	M12X1,5	12,5	1 - 5	16	18	6,5	16-20	100
2910.M16N	M16X1,5	16,5	2,5- 7	20	23	7,0	20-25	100
2910.M20N	M20X1,5	20,5	5 -10	24	27	8,0	20-27	50
2910.M25N	M25X1,5	25,5	6 -13	29	32	8,0	24-30	50
2910.M32N	M32X1,5	32,5	7 -14	36	40	9,0	27-34	25
2910.M40N	M40X1,5	40,5	13 -23	45	50	9,0	34-42	10
2910.M50N	M50X1,5	50,5	20 -29	54	60	10,0	35-43	8
2910.M63N	M63X1,5	63,5	27 -39	67	74	15,0	40-52	5

**MAXIbrass<sup>®</sup> extended thread**
**Metric thread M 1.5 pitch CEI EN 60423 CEI EN 50262**

Ref. Nickel Plated Brass	P	Fixing Hole Ø (mm)	Ø A min-max (mm)	B Spanner (mm)	E (mm)	C (mm)	L min-max (mm)	Quantity
2901.M12N	M12X1,5	12,5	3 - 7	16	18	12	16-20	100
2901.M16N	M16X1,5	16,5	4,5-10	20	23	12	20-25	100
2901.M20N	M20X1,5	20,5	7 -13	24	27	12	20-27	50
2901.M25N	M25X1,5	25,5	10 -17	29	32	12	24-30	50
2901.M32N	M32X1,5	32,5	11 -21	36	40	15	27-34	25
2901.M40N	M40X1,5	40,5	19 -28	45	50	15	34-42	10
2901.M50N	M50X1,5	50,5	26 -35	54	60	15	35-43	8

**MAXIbrass<sup>®</sup> extended thread and reduced cable entry**
**Metric thread M 1.5 pitch CEI EN 60423 CEI EN 50262**

Ref. Nickel Plated Brass	P	Fixing Hole Ø (mm)	Ø A min-max (mm)	B Spanner (mm)	E (mm)	C (mm)	L min-max (mm)	Quantity
2911.M12N	M12X1,5	12,5	1 - 5	16	18	12	16-20	100
2911.M16N	M16X1,5	16,5	2,5- 7	20	23	12	20-25	100
2911.M20N	M20X1,5	20,5	5 -10	24	27	12	20-27	50
2911.M25N	M25X1,5	25,5	6 -13	29	32	12	24-30	50
2911.M32N	M32X1,5	32,5	7 -14	36	40	15	27-34	25
2911.M40N	M40X1,5	40,5	13 -23	45	50	15	34-42	10
2911.M50N	M50X1,5	50,5	20 -29	54	60	15	35-43	8

**Cembre SpA**

Via Serenissima, 9 - 25135 Brescia (Italy)

Tel.: +39 030 36921 - Fax: +39 030 3365766

Web: www.cembre.com - Email: info@cembre.com

Prepared by: Marketing dept.



Date: 09/02/2010

---

**COMPRESSION CABLE GLANDS NICKEL PLATED BRASS  
MAXIBRASS 2900 SERIES - METRIC THREAD****Technical details:**

PROTECTION :		IP 68 (EN 60529:1991 / CEI 70-1)
MATERIAL :		CuZn39Pb3 Nickel Plated
NICKEL PLATING THICKNESS :		2 ÷ 4 µm
SEALING RING:		NEOPRENE®
TEMPERATURE RANGE :		-25°C ÷ +100°C (continuous)
CABLE GRIP INSERT :		POLYAMIDE PA6.6
O-RING :		Nitrile 70Sh A
IMPACT CATEGORY :	M12	5 (EN 50262:1999)
	M16÷ M63	6 (EN 50262:1999)
TORQUE SETTINGS :	M12 and M16	6 Nm
	M20 and M25	8 Nm
	M32	12 Nm
	M40 , M50 and M63	18 Nm

**Marks:**

	<b>VDE:</b>	<b><i>licence Nos 40008472, 4008474, 40008475 e 40008476 (EN 50262: 1999)</i></b>
	<b>USL-CNL:</b>	<b><i>UL LISTING File No E220310; control No 48SB (UL 514B) valid in USA &amp; Canada</i></b>
	<b>USR-CNR:</b>	<b><i>UL RECOGNITION File No E220310 (UL514B) valid in USA &amp; Canada</i></b>

**Markings:**

 **(EN 50262: 1999)**

**Cembre SpA**

Via Serenissima, 9 - 25135 Brescia (Italy)  
Tel.: +39 030 36921 - Fax: +39 030 3365766  
Web: [www.cembre.com](http://www.cembre.com) - Email: [info@cembre.com](mailto:info@cembre.com)

Prepared by: Marketing dept.

Date: 09/02/2010